

WIDE FORMAT SOLUTIONS



**Minuteman
Press**®Cambridge

The **COMPLETE**
Commercial
Print Solution



01223 312688
printcambridge.co.uk



Welcome to Minuteman Press Cambridge

We've been proudly printing for Cambridge since 2009 - our in-store machines, along with a team of dedicated print and design specialists, will always meet your print and promotional needs.

We print for everyone: business, education, corporate, or personal. Our experienced team will bring your print ideas to life. What's more, our city location and onsite capabilities ensure a quick turnaround and the highest print quality. With the added convenience of bike courier delivery, going local couldn't be easier.





Contents

Posters	1
Architect Plans	2
Vinyl Banners	3
Arena Frame	4
Barrier Systems	5
Pull Up Banners	6
Pop Up Systems	7
Display Signage	9
Wall Signs	11
Signage Boards	13
Stickers	17
Wallpaper & Graphics	18
Window Manifestations	19
Flags	21
Bollard Covers	22
Vehicle Graphics	23
Commercial Printing	24

Posters

Our large format posters are printed on a wide format 10 colour photo printer. This printer gives exceptional results and allows us to print your posters in rapid time. If you need a large custom size photograph or a great quality art-print reproduction, we will give you the highest quality. We only print on top range 260gsm photo satin paper or 220gsm matt paper to ensure you receive the best quality product.



Architect Plans

Our Hewlett Packard architect printer will turn round your plans with rapid speed and high quality. We can print full colour and greyscale in sizes A3 to A0. Same day service available.

We don't laminate plans here, we are an eco friendly printer so we opt to print on recycled polyester media that is waterproof and durable.

“ Waterproof?
Have your plans printed onto our waterproof polyester stock. Its tough and rollable!
”

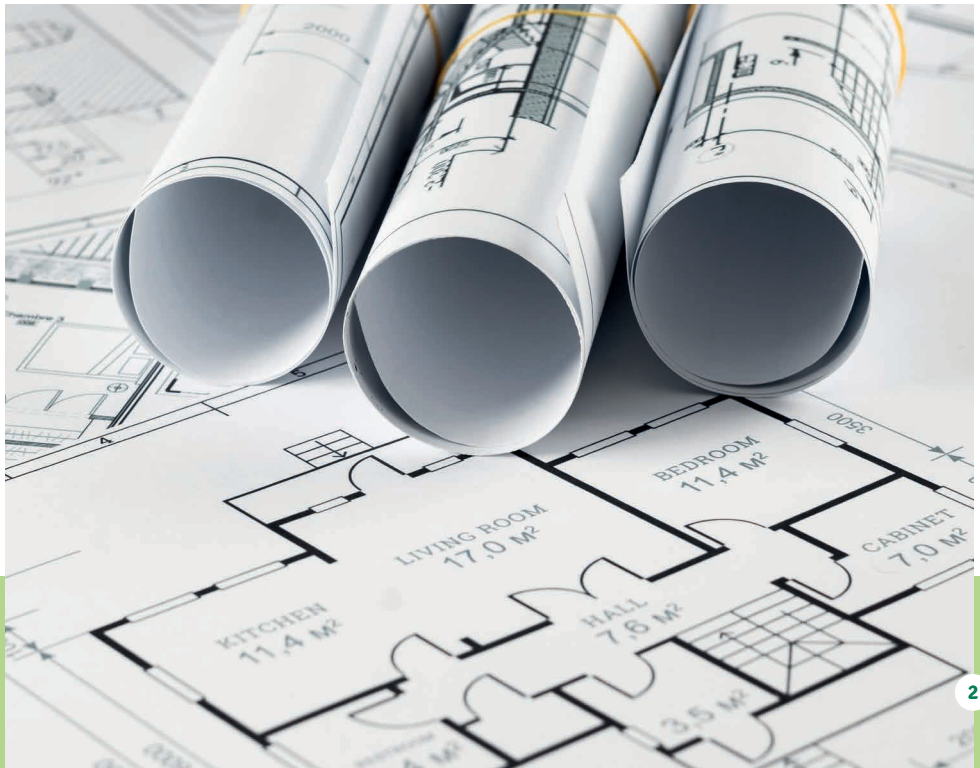

Vinyl Banners

We offer premium quality digitally printed PVC banners at a great price. 500gsm banner material creates long-lasting, waterproof banners. Our 1.6m wide large format banner printer produces vibrant colours at huge sizes to help make sure your banners make a real impact.

All banners can be hemmed and eyeleted to your specification, and we can create pockets for scaffolding or pole mounted banners.

Mesh Banners?
We also offer a range of mesh banners which are perfect for heras fencing or windy conditions.



Arena Banner Frames

Full-size advertising hoarding goes portable with the ingenious design of the Arena banner. Lightweight yet strong, the aluminium a-frame slots together without tools in minutes. Graphics are mounted using simple bungee straps for optimal tensioning and excellent wind resistance. Arena is perfect for use with PVC banners when you need a free-standing option that will stand up to tough weather conditions.

Arena can be used either single or double sided and is supplied with ground pegs for a completely secure installation. Ideal for advertising or corporate sponsorship at any outdoor or sporting event, when it's time to head home the Arena collapses down into an incredibly compact and lightweight carry bag for supreme portability and convenience.

Available in 1000x2500mm or 1250x3000mm sizes, the Arena banner also has an optional extension kit to allow you to display extra wide graphics.



Barrier Systems

An essential for coffee shops, restaurants and bars seeking to embrace street culture while maximizing square footage, Our range of café barriers offers robust performance and generous branding opportunities.

Available in black or a polished steel finish with two sturdy supports mounted on wide, weighted bases for optimal stability. The robust top rail connects without tools for quick assembly and convenient banner changes, and is secured to the base with spring clips.



Pull Up Banners

Our high quality, single-sided roller banner. Easy to use with two twist-out feet for support and a three-section bungee pole, comes packed in a padded carry bag.

Premium quality graphics are printed on supersmooth blockout material and can be ordered from 850mm up to 2000mm, perfect for any location to create the impact you desire.



“Mini Pull Ups!
Our A3 desktop pull ups make a great advertising tool. It's perfect for exhibitions, reception areas, restaurants & more.
”



Pop up Systems

The 3x2 Pop up stand is one of our best sellers. Set up in 10 minutes with no tools and fits in the boot of your car. No other modular display system gives you the features and portability of a 3x2 Pop up display.

Our 3x2 pop up display consists of 5 printed magnetic graphic panels which are anti-glare, non-reflective and matt laminated. Tear and scratch resistant graphic panels keeps your pop up looking new.

Portable display case on wheels with beech inlay counter conversion top, creating a handy desk. Hook over graphic panel attachment system with magnetic technology for quick change of graphics, meaning you can buy replacement panels without the cost of a whole new system.

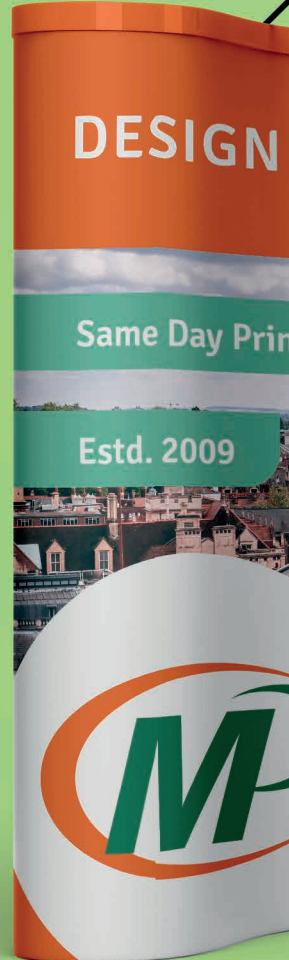
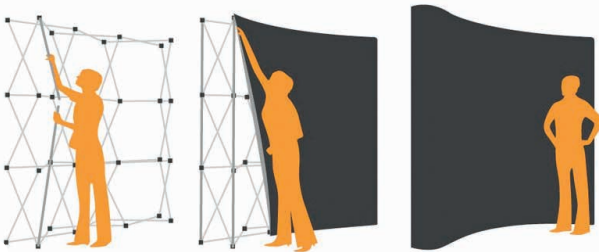
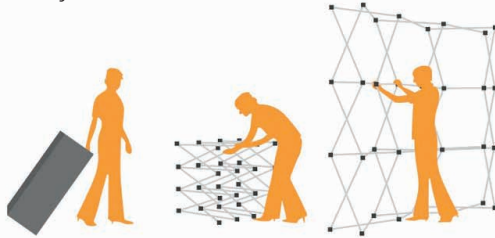

“ Simple!
Super quick set up makes creating
a huge display effortless! ”

| PRINT | PROMOTIONAL

ating*



* Same day printing depending on product availability

in f @ @minutemancams

MP Minuteman
Press Cambridge
WE DESIGN, PRINT & PROMOTE...YOU!

www.printcambridge.co.uk

01223 312 688

Display Signage

Our range of display signage will enable you to show your company in the biggest way possible. Whether you are needing a display system for your exhibition or an outdoor signage board, we will have a signage system that works for you.



“ **Contour Cut**
We can custom cut your sign into any shape to give a truly one off design. ”



We also offer a range swing signs in A2 and A1 sizes. Quick clip hanging straps hold a rigid foam board panel in place. Graphics are suspended from a powder coated black frame.

Our premium range of A boards have vinyl application areas that we apply direct too. This creates a permanent sign whilst having the option to replace the main graphics.



Wall Signage

We have some excellent wall signage, chalkboard and poster display solutions available for wall mounting with weather resistant properties suitable for outdoor or indoor use.

Our Poster Frames, Noticeboards and Menu Cases range includes low voltage LED illuminated options. It also includes a range of Snapframes, the widely popular front opening aluminium poster frame that wins on price and functionality.

“ **Lighting?**
Some of our snapframes have internal LEDs to illuminate your poster giving you 24 hour advertising ”

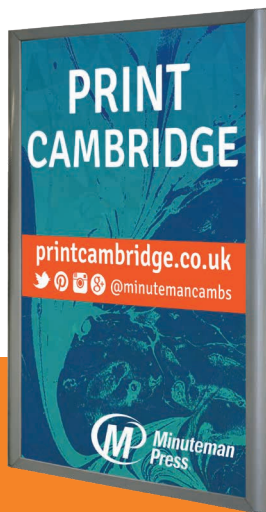



**Wall Signage
Solutions**

Signage Boards

Foamex

A superb material for both indoor and outdoor signage. This subtly flexible and strong plastic board is very popular with advertising hoardings and outdoor signage. It is an extremely versatile, lightweight and stays unaffected by the weather. Our boards come with crystal matt or gloss lamination.

Correx

A 4mm, fluted plastic board often linked with estate agents signs. This is a lightweight weatherproof board. Due to its more economical nature than Foamex, Correx is ideal for short term or temporary signage.

Dibond

Aluminium dibond signs are an excellent long-term signage solution for businesses. Our weatherproof signage board is ideal for shops, outdoor displays, property development hoardings and directional signage. Available in a selection of different sizes and custom shaped cutting styles. Aluminium signs are a sure-fire way to get the message seen.

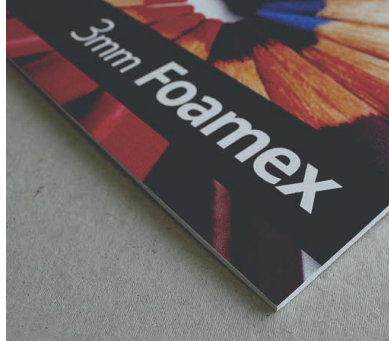



waterproof

Foamex Display Boards

Welcome Signs

Order of the Day

Seating Plan

1.3, 3, 5 & 10mm available

Signage Boards

Acrylic

High class wall mounted office door signs and restaurant menu holders, our acrylic sign options are great for creating high end displays. Acrylic also boasts low moisture absorption qualities, high resistance to chemicals and UV resistance. With great optical clarity and strong weather resistance, clear acrylic sheets are a cheaper, lighter and safer alternative to glass.

Your acrylic sign will be produced using clear acrylic, available in a variety of thicknesses: 3mm, 5mm and 10mm. We also have options for rounded corners and chrome or satin stand off mounts.

Getting creative!

Much like design, the skies the limit with signage solutions. We can custom cut the mounting media and vinyl that can be applied to it. We only use top quality materials and are always on the look out for new innovative ones to push the envelope of what is possible. If you have any ideas please get in touch, or we can come and visit your premise to advise on what is possible.

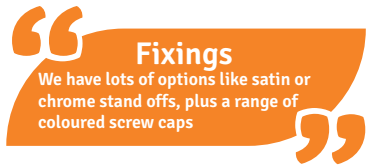



Stickers

Monomeric vinyl

Our self-adhesive monomeric stickers are perfect for marketing and promotion. You can customise your design to create the size of stickers you need for your advertising purposes. Use for promotional stickers, events, trade-shows, marketing or anything else you can think of. Our monomeric vinyl is rated for 3-4 years.

Coloured sign vinyl

Vinyl lettering is made from weatherproof materials that can be used outdoors as easily as inside. Vinyl lettering and numbering is a great way to add signage to your office wall, vehicle or shop front windows. We have a range of colours and effects, with matt or gloss options available. Pop in store to see our full range of options.

Floor Vinyl

Our self-adhesive vinyl indoor floor stickers have a non-slip grain-textured finish in compliance with R10 UK safety regulations and are scuff and scratch resistant. They are incredibly easy to apply, are wipe-clean and can be easily removed without damaging your floor. As with all our vinyls we can cut to size or contour cut to a specific shape.



Window Signs
Our contour cut vinyls are perfect for office or shop front windows.

Wall Paper & Graphics

Wall graphics are an excellent way to transform your walls and put your stamp on every aspect of your space. They are an affordable and effective way of making the most out of your wall space, and are increasingly used in all manner of settings including business, retail, or hospitality premises, and in the home. We offer a comprehensive end-to-end service which includes site visits, graphic design, digital printing and precision cutting, and professional installation (or any combination of these services to suit your requirements).



Window Manifestations

Frosted Window Film

Frosted window graphics give you the ability to display information and provide screening whilst still allowing maximum light into your business premises. From a simple logo, an intricate design, or large frosted panels, we can design and install your frosted and etched window graphics to give your window signs a first-class professional finish.

Providing both branding and the ability to display information with your window signage, frosted glass window vinyls can also help reduce glare or increase insulation within the premises.

One Way

One way vision film or Contra Vision, is a perforated vinyl film that allows you to create innovative advertising and signage using your window spaces. The beauty of one way vision films for printed window graphics is that you can take advantage of your glazed areas without obstructing the view. Windows graphics allow people within the building to see out, while providing privacy from those outside, extending your business workspace and storage areas.

Whether using one way vision printed graphics for advertising, directional signage, privacy screening or to reduce sun glare, the use of these perforated window films gives you the flexibility to highlight and define glass areas in a way to suit your business, making bold statements or subtle design enhancements.



The COMPLETE
Commercial
Print Solution



Flags

Our flags can be a great way of showing your logo at an exhibition and drive customers or clients to your stand. They are easy to assemble and include a carry bag. We offer 'tear drop' and 'feather' shape and can print either one side or both. We can supply ground spikes or water bases to secure your flag. We have a range of sizes so, please enquire to find out what works best for you.



Bollard Covers

Give your clients all the benefits of this eye-catching display option – perfect for advertising a shop re-opening! These three-sided Correx® by Corplex covers come pre-creased with glue-free fastening tabs and are suitable for bollards up to 205mm in diameter. They make for sturdy, waterproof displays and are commonly used for outdoor campaigns.



Vehicle Graphics

From tradesmen, catering businesses to online retailers, vehicle graphics can make your brand stand out on the road. Branded company vehicles give you your business vital marketing opportunities when you least expect them, every single day. Branding your own vehicle is a cost effective solution that guarantees exposure within your local area and can help solve those marketing problems.

Single colour or full colour printed designs can be applied to any vehicle, even boats and planes. We offer a basic signage package which consists of contour cut logos and graphics.



Commercial Printing

Our core printing service has always been based on small format printing on any scale. our in-store machines, along with a team of dedicated print and design specialists, will always meet your print and promotional needs.

We print for everyone: business, education, corporate, or personal. Our experienced team will bring your print ideas to life.

“ Did you know? ”
We also print promotional items, from pens, lanyards, tote bags and much more!

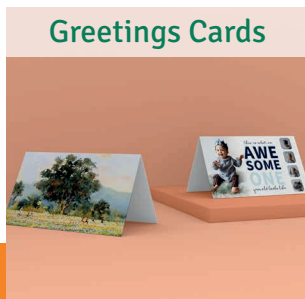
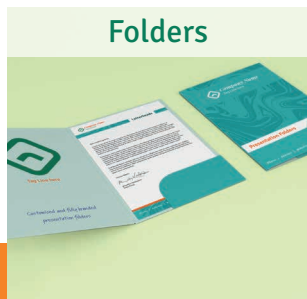

and so much more...

Looking for more?

The products featured within this booklet are just a selection of the many items we offer. If you have a requirement not mentioned, we can probably help with that too! Get in touch:

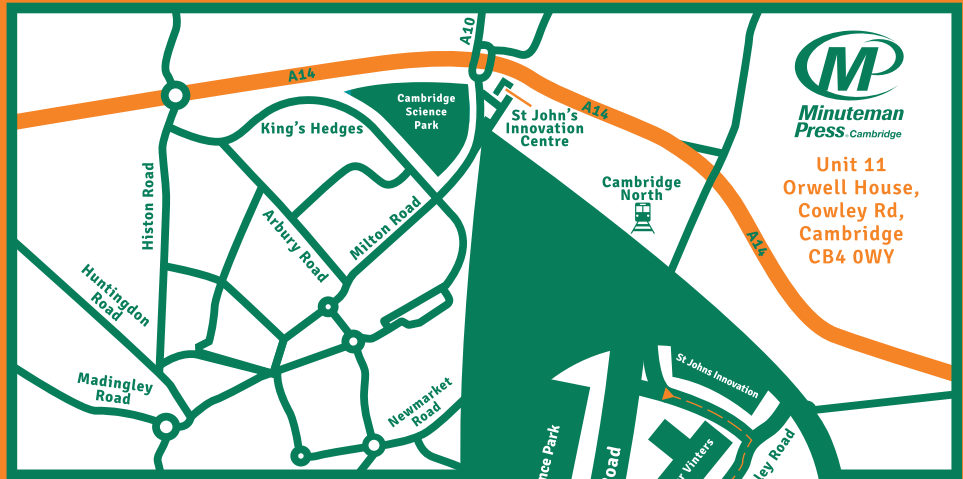

Unit 11
Orwell House,
Cowley Rd,
Cambridge
CB4 0WY

 Minuteman Press Cambridge
Unit 11, Orwell Furlong
Cowley Road, Cambridge CB4 0WY

 01223 312688

 www.printcambridge.co.uk

 studio@minutemanpress.com

@minutemancams

